

**2,400± Sq. Ft. Office / Warehouse  
Jetport Interstate Commerce Park  
FOR LEASE**



**LOCATION:** 13891 Jetport Loop, Unit 5, Fort Myers, FL 33913

**ZONING:** IL - Light Industrial

**SIZE:** 2,400± Sq. Ft

**UTILITIES:** County Water & Sewer

**PRICE:** \$2,000.00 Monthly plus Sales Tax (\$7.00 PSF NNN + \$3.00 PSF CAM)

**COMMENTS:** Warehouse unit with approximately 1,044± sq. ft of office area, two restrooms, break room and one over head door. Water, sewer and trash included in CAM. Pylon signage available for \$110 a month. Convenient access to Treeline Avenue and Daniels Parkway, just off Interstate 75, Exit 131. See reverse side for more details.

**CONTACT:** TODD HOLMAN  
**PHONE:** (239) 425-6014  
**E-MAIL:** tholman@wa-cr.com

**CONTACT:** JOHN KREMSKI, CCIM  
**PHONE:** (239) 425-6017  
**E-MAIL:** john@johnkremski.com

# 13891 Jetport Loop, Unit 5, Fort Myers, FL 33913

## Site Plan

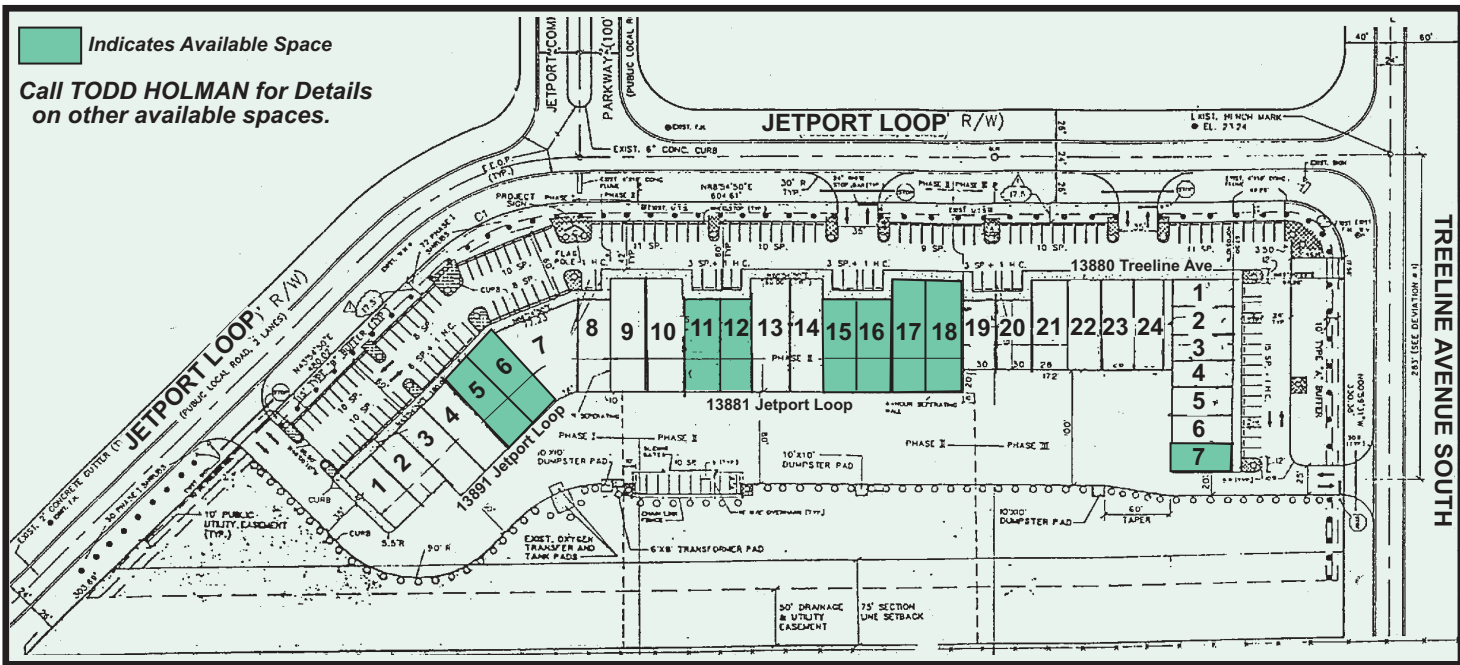

**FLOOR PLAN FOR  
UNIT 5  
COMING SOON**

