

# Daniels Center Phase III

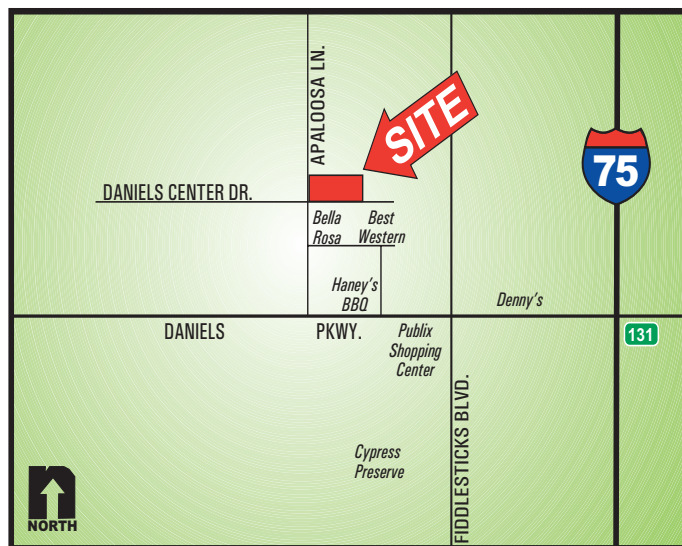

**LOCATION:** 8971 Daniels Center Drive,  
Fort Myers, FL

**ZONING:** CPD - Commercial Planned Development



**COMMENTS:** Newly built single story, stucco finish, garden office located in the heart of growth in Lee County. Just off Daniels Parkway, the newly constructed Daniels Center has ample parking and easy access to I-75. Phase I & Phase II are SOLD OUT! Phase III to start January 2005.

**CONTACT:** TODD HOLMAN  
**PHONE:** (239) 425-6014  
**E-MAIL:** tholman@dw-cr.com

**CONTACT:** STEVE WOOD  
**PHONE:** (239) 425-6027  
**E-MAIL:** swood@dw-cr.com

7800 University Pointe Drive  
Suite 100, Second Floor  
Fort Myers, FL 33907  
Phone: (239) 425-6000  
Fax: (239) 425-6001  
[www.DW-CR.com](http://www.DW-CR.com)

# 8971 Daniels Center Drive, Fort Myers, FL

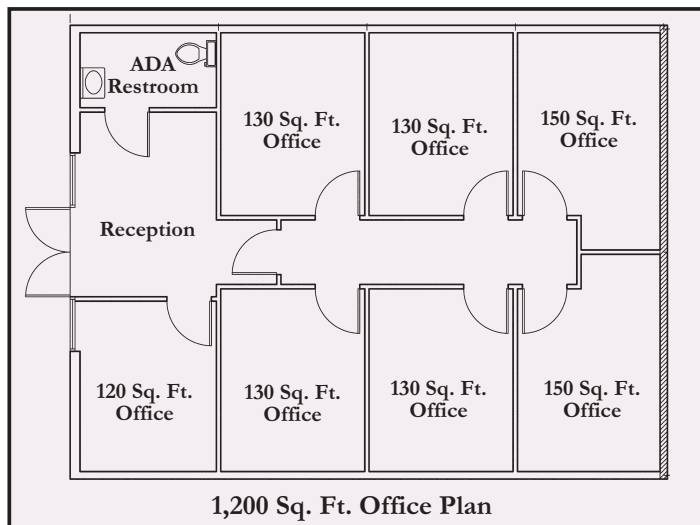
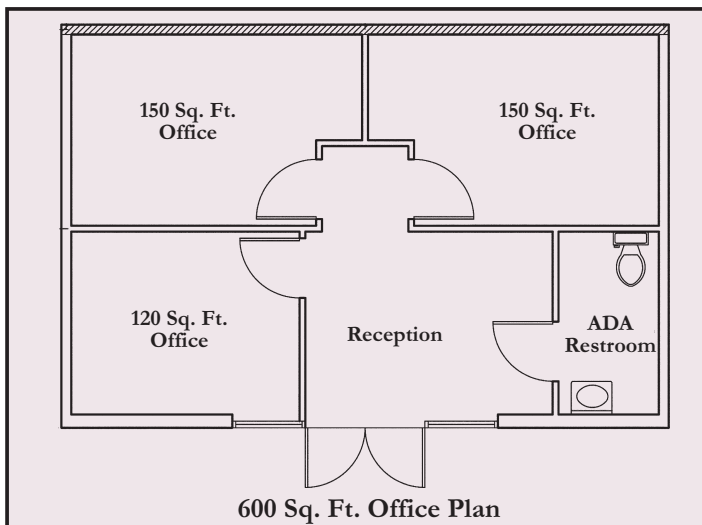

*Move right in to a finished office space or Design your own with the improved shell*

SIZE	IMPROVED SHELL PRICE	FINISHED OFFICE PRICE
600 Sq. Ft.	\$106,950.00	\$113,850.00
900 Sq. Ft.	\$160,425.00	\$170,775.00
1,200 Sq. Ft.	\$213,900.00	\$227,700.00

*All prices include an ADA restroom  
Common Area Maintenance charge of \$3.85 Per Sq. Ft.*

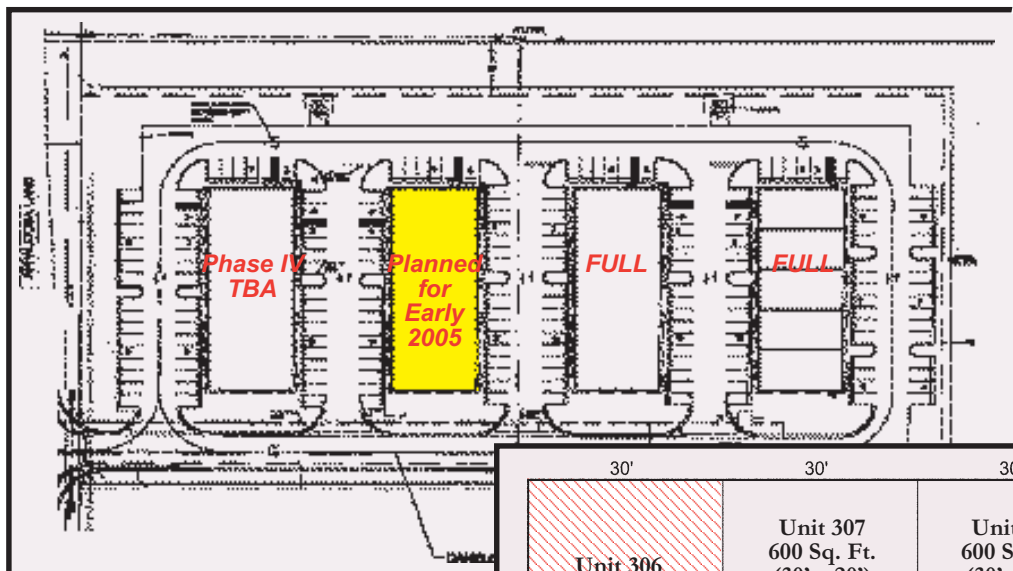

Unit 306 900 Sq. Ft. (30' x 30')	Unit 307 600 Sq. Ft. (30' x 20')	Unit 308 600 Sq. Ft. (30' x 20')	Unit 309 600 Sq. Ft. (30' x 20')	Unit 310 900 Sq. Ft. (30' x 30')
Unit 305 900 Sq. Ft. (30' x 30')	Unit 304 1,200 Sq. Ft. (30' x 40')	Unit 303 1,200 Sq. Ft. (30' x 40')	Unit 302 1,200 Sq. Ft. (30' x 40')	Unit 301 900 Sq. Ft. (30' x 30')

*Adjoining offices can be combined to create the right size for your business needs.*

Indicates Units Under Contract