



**LOCATION:** 21371 Palm Beach Boulevard, Alva, FL 33920

**STRAP #:** 27-43-27-00-00011.0000

**ZONING:** Alva Commercial Overlay

**SIZE:** 1.04± Acres / 200'± Frontage

**PRICE:** \$320,000

**COMMENTS:** Parcel may be adjoined with the adjacent parcel for a total of 3.54± acres with frontage on State Road 80 and Broadway Street. Located in an area of strong residential & commercial growth. Residential developments in the area include: Verandah, Greenbriar, Lehigh Lakes, Wellington Ranch and River Hall.

**CONTACT:** TOM WOODYARD  
**PHONE:** (239) 425-6011  
**E-MAIL:** [twoodyard@wa-cr.com](mailto:twoodyard@wa-cr.com)

The statements and figures presented herein, while not guaranteed, are secured from sources we believe authoritative. Subject to prior sale, lease, withdrawal and price change without notice.

# 21371 Palm Beach Boulevard, Alva, FL 33920

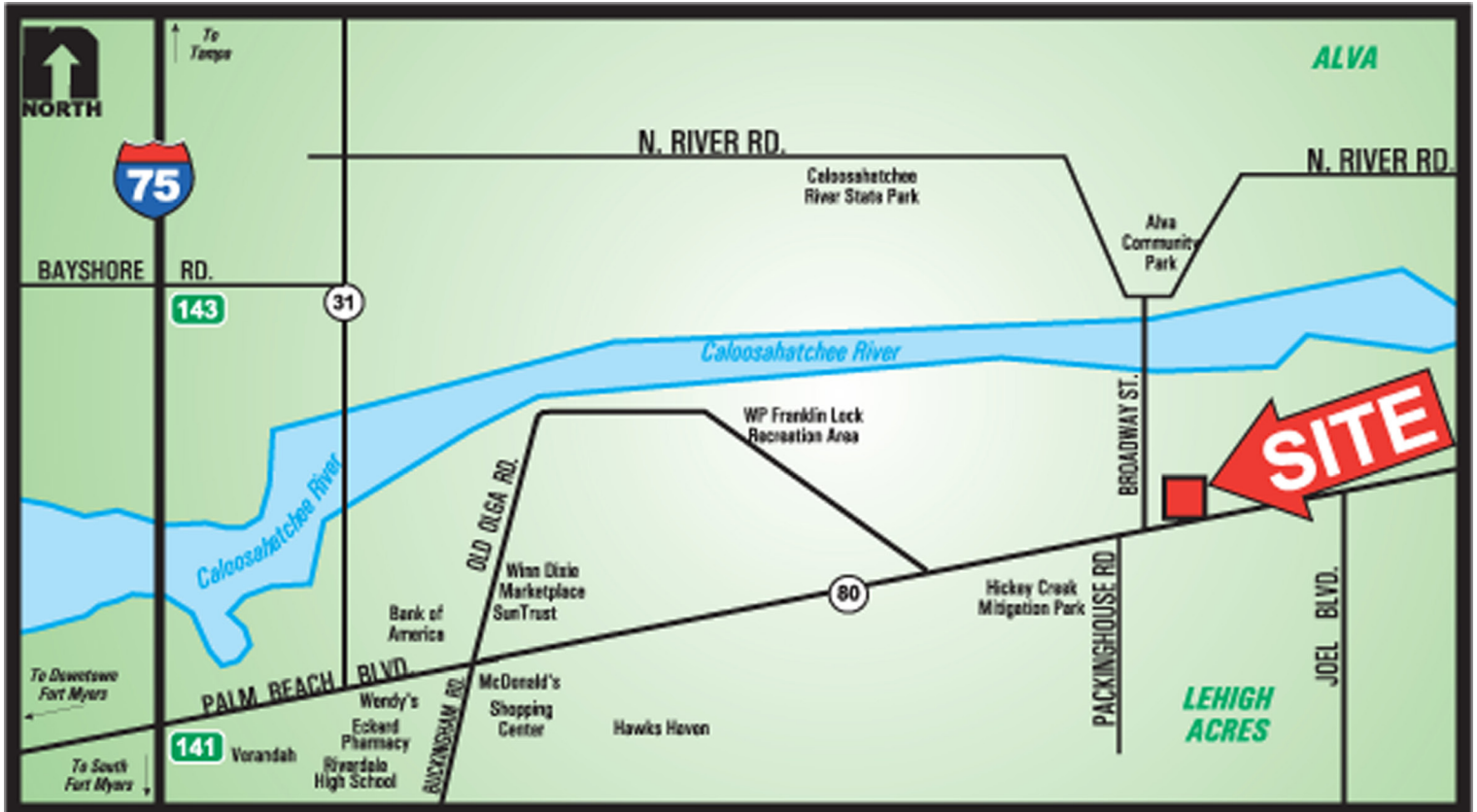
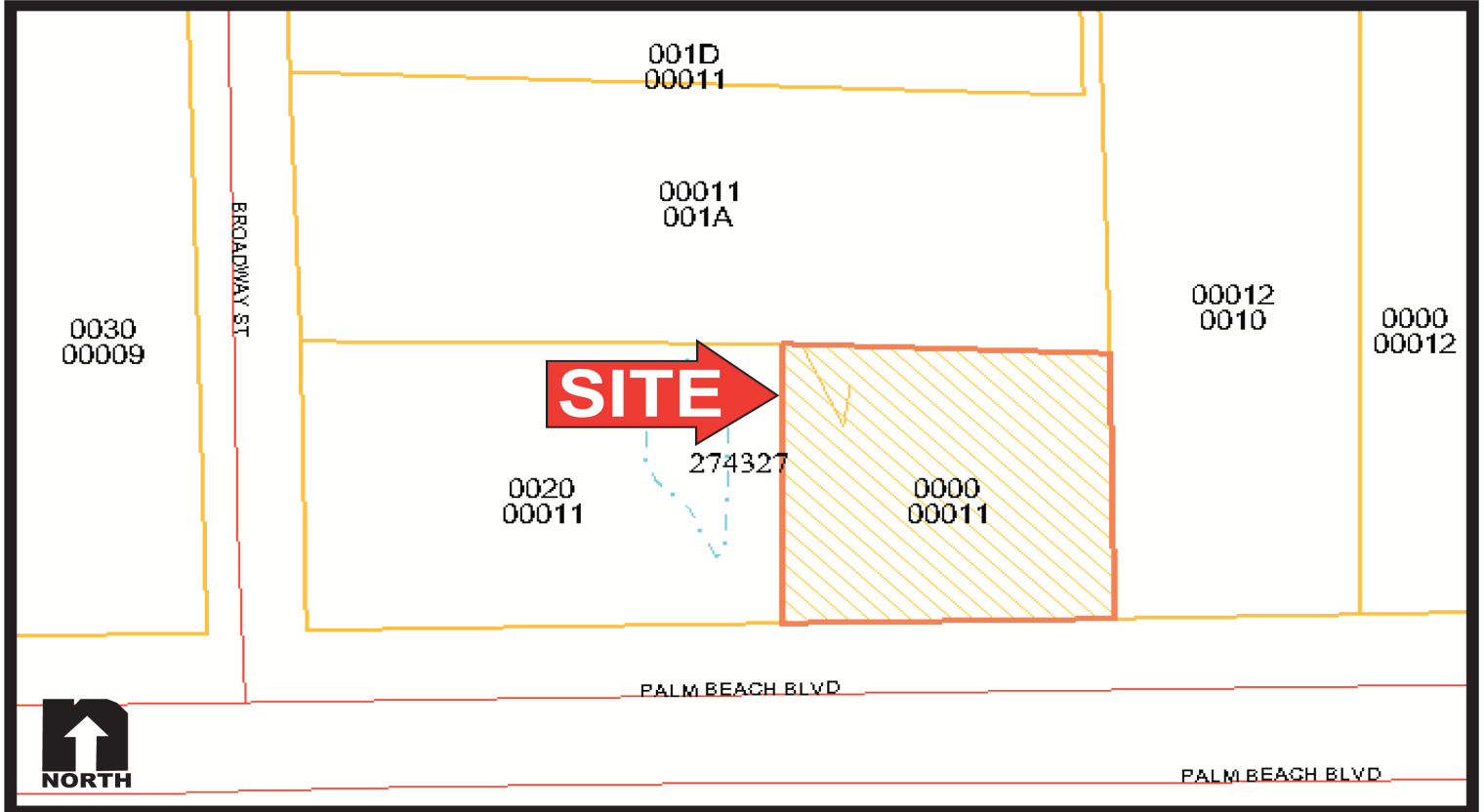

The statements and figures presented herein, while not guaranteed, are secured from sources we believe authoritative. Subject to prior sale, lease, withdrawal and price change without notice.