

Landshore Industrial Condo Office/Warehouse Unit FOR LEASE



LOCATION: 1685 Target Court, Unit 24, Fort Myers, FL 33905

PARCEL ID: 16-44-25-P1-01102.0024

ZONING: PUD - Planned Unit Development

UTILITIES: City Water & Sewer

PRICE:

| UNIT | SIZE | BASE RENT | RENT / MO | SALES TAX / MO | MONTHLY TOTAL |
|--|-----------|-------------|------------|----------------|---------------|
| 24 | 1,897± SF | \$12.95 PSF | \$2,047.18 | \$122.83 | \$2,170.01 |
| Industrial Gross Lease / Minimum 3 year term / 3% annual increases | | | | | |

COMMENTS: IMMEDIATE OCCUPANCY! 1,897± SF office/warehouse unit with (1) 12x12' overhead door, 14' eave height, 175± parking spaces total. Located at the Landshore Industrial Condominiums, two minutes from I-75, Exit 138. Great location for small construction or distribution.

CONTACT: TODD HOLMAN
PHONE: (239) 425-6014
E-MAIL: tholman@wa-cr.com

The statements and figures presented herein, while not guaranteed, are secured from sources we believe authoritative. Subject to prior sale, lease, withdrawal and price change without notice.

1685 Target Court, Unit 24, Ft. Myers, FL 33905

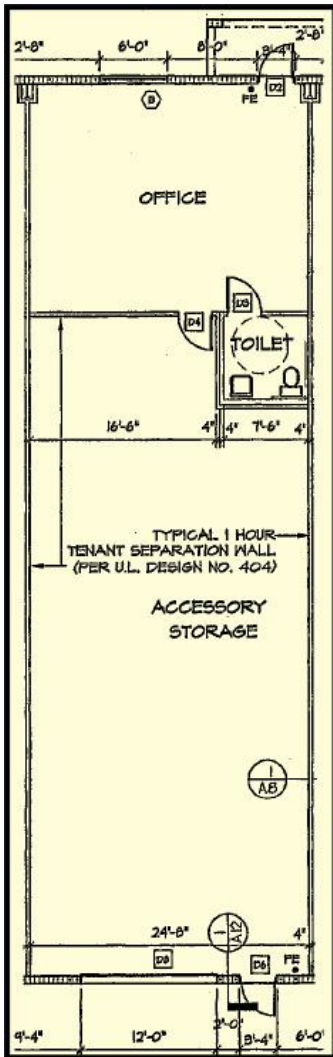
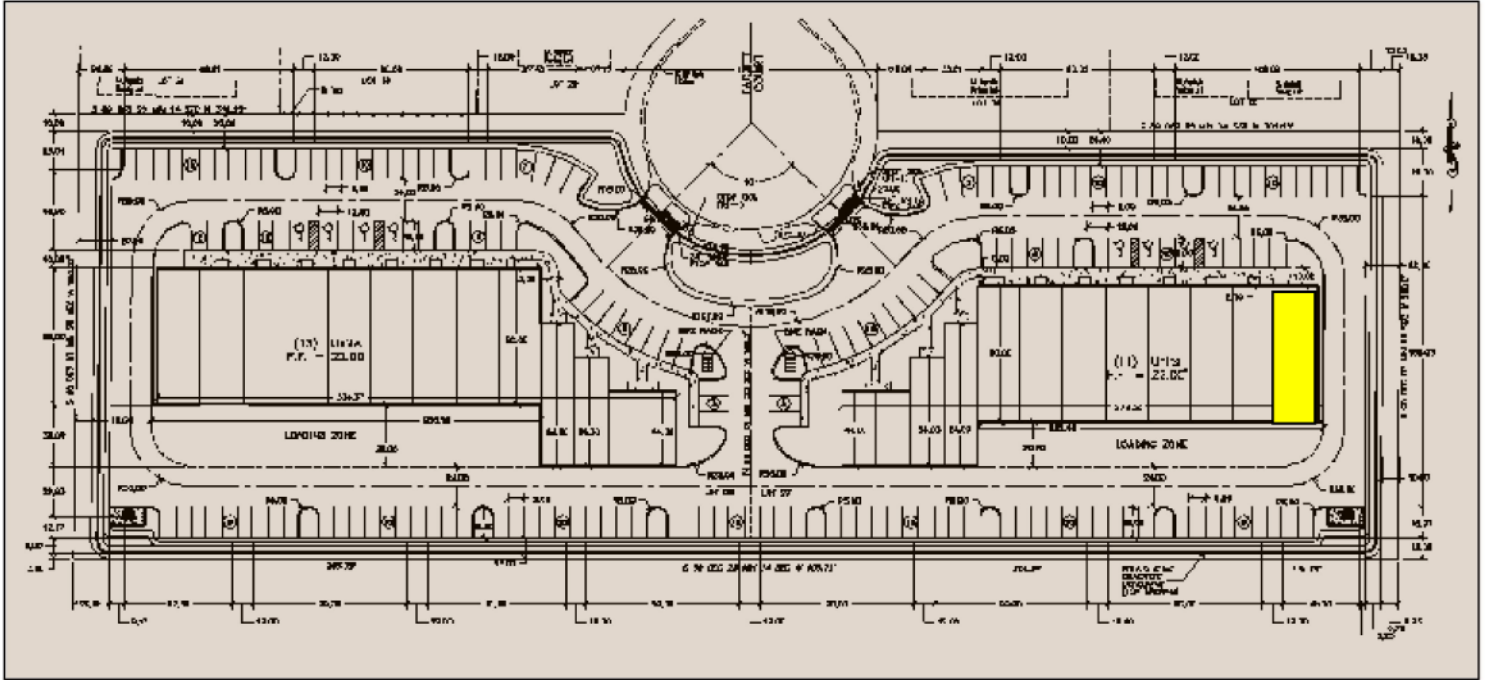

The statements and figures presented herein, while not guaranteed, are secured from sources we believe authoritative. Subject to prior sale, lease, withdrawal and price change without notice.