

Metro Commercial Park Office / Warehouse Space For Sale



LOCATION: 12165 Metro Parkway, Units 9 & 10, Fort Myers, FL 33966

ZONING: IL - Light Industrial

UTILITIES: County Water & Sewer

SIZE: 1,423± Sq. Ft. Total (324± Sq. Ft. Office Area and 1,099± Sq. Ft. Warehouse)

SALES PRICE: \$83,957 or \$59 psf

ASSN FEES: \$260 per Month

COMMENTS: Warehouse unit with 324± sq. ft. of office space. Truck access to overhead door in rear of unit. Located on the east side of Metro Parkway just north of Crystal Dr. See reverse side for more information. Unit available on 6/01/15.

CONTACT: TODD HOLMAN
PHONE: (239) 425-6014
E-MAIL: tholman@wa-cr.com

The statements and figures presented herein, while not guaranteed, are secured from sources we believe authoritative. Subject to prior sale, lease, withdrawal and price change without notice.

12165 Metro Parkway, Units 9 & 10, Fort Myers, FL 33966



Floor Plan

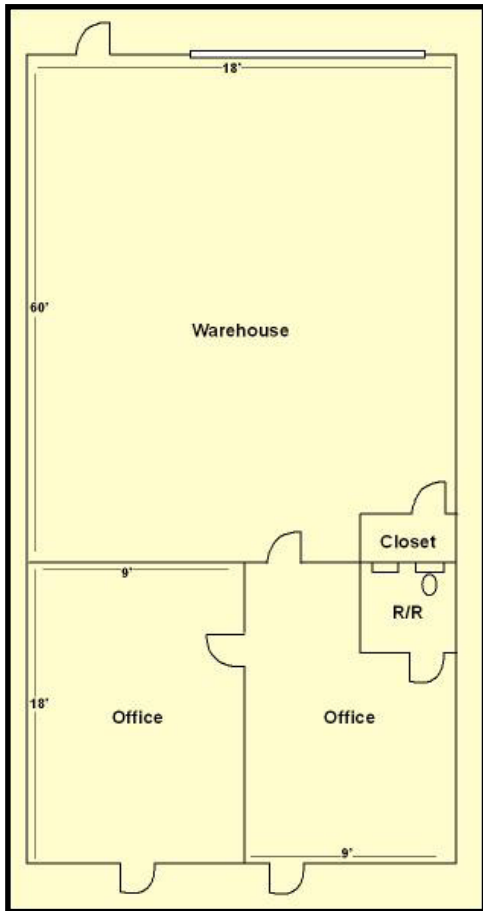

Site Plan

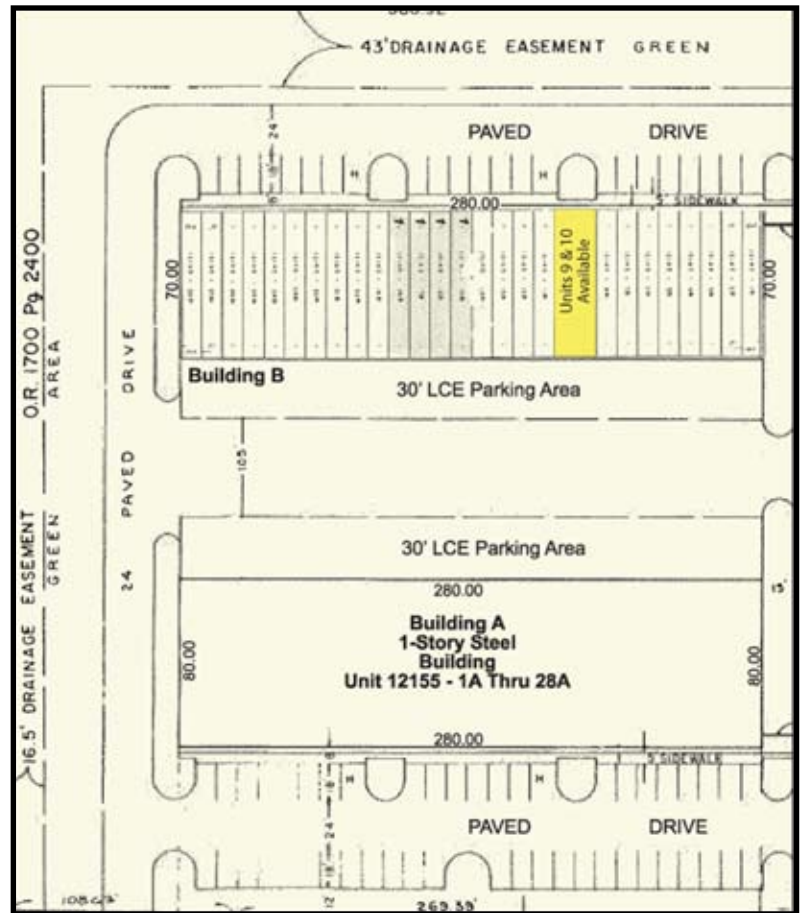

The statements and figures presented herein, while not guaranteed, are secured from sources we believe authoritative. Subject to prior sale, lease, withdrawal and price change without notice.