



LOCATION: 928 NE 24th Lane, Units 6-7, Cape Coral, FL 33909

ZONING: I1 - Industrial

SIZE: 2,400± Sq. Ft

UTILITIES: City water and sewer

2006 TAXES: \$2,967.00

PRICE: \$276,000.00

COMMENTS: Two 1,200± sq. ft. condo units currently combined into one unit. Includes two overhead doors. Seller will divide. Month to month tenants in place. Located in the North Cape Coral Industrial Park just off of Kismet Pkwy.

CONTACT: TODD HOLMAN
(239) 425-6014
E-MAIL: tholman@wa-cr.com

CONTACT: JOHN KREMSKI, CCIM
(239) 425-6017
E-MAIL: john@johnkremski.com

928 NE 24th Lane, Cape Coral, FL 33909

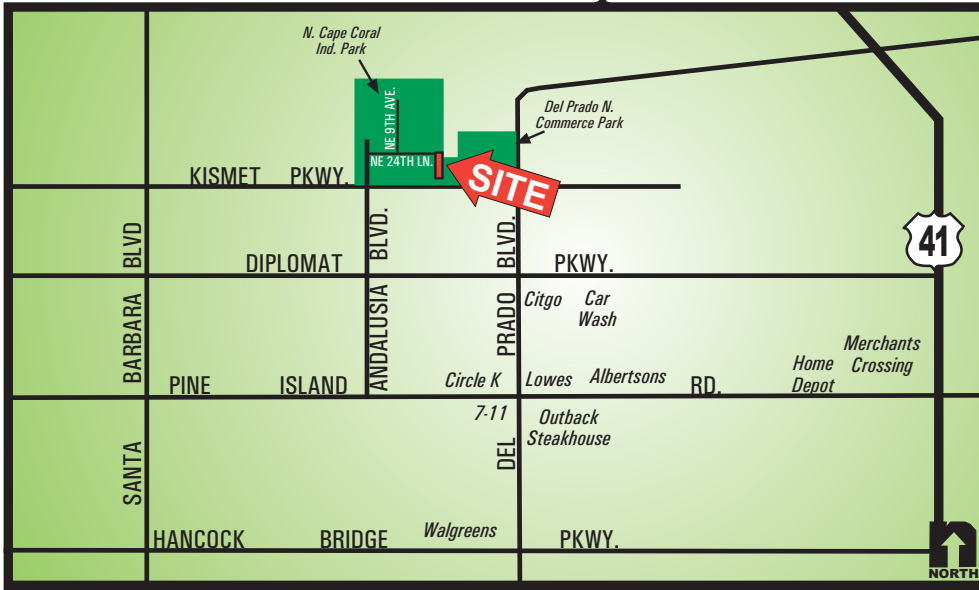

Site Plan

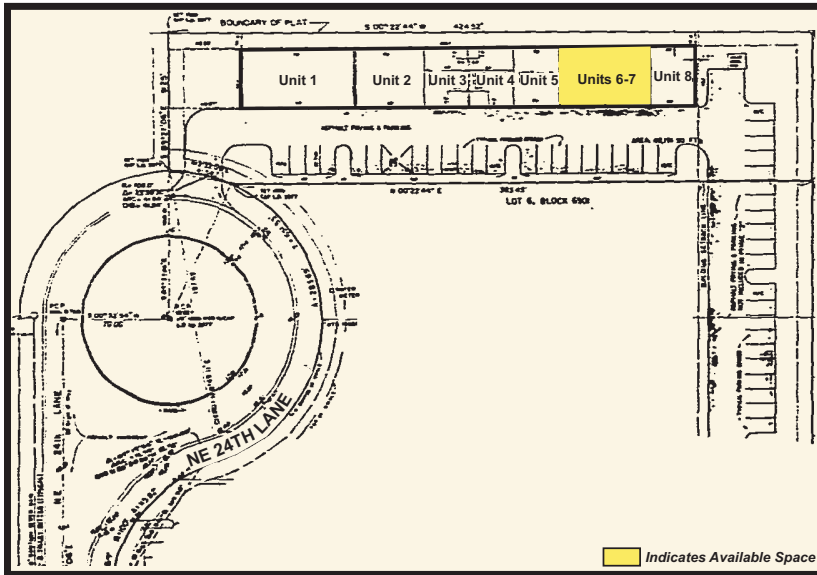

The statements and figures presented herein, while not guaranteed, are secured from sources we believe authoritative. Subject to prior sale, lease, withdrawal and price change without notice.