

**Landshore Industrial Condos  
Office / Warehouses For Sale  
Benchmark Corporate Park**



**LOCATION:** 1684 & 1685 Target Court, Fort Myers, FL 33905

**STRAP #:** 16-44-25-P1-01000.0270

**PARKING:** 175± Spaces

**ZONING:** PUD - Planned Unit Development

**OH DOORS:** 12 Ft. x 12 Ft.

**UTILITIES:** City Water & Sewer

**EAVE HEIGHT:** 14 Ft.

**USE:** Office / Warehouse

UNITS	OFFICE SQ. FT. (Approx)	STORAGE SQ. FT. (Approx)	TOTAL Sq. Ft. (Approx Floor Area)	SALE PRICE EACH
1, 8 & 17	515	1,388	1,903	\$161,755
2-7, 9 & 19	515	1,427	1,942	\$165,070
10	415	1,153	1,568	\$133,280
11	415	830	1,245	\$105,825
12	415	425	840	\$ 71,400
13	415	403	818	\$ 69,615
14	415	406	821	\$ 69,785
15	415	427	842	\$ 71,570
16	1,192	1,555	2,747	\$233,495

**COMMENTS:** Located at the Benchmark Corporate Park, two minutes from I-75, Exit 138. Great location for small business or income property. Large parking lot. Also, available for lease. See our lease brochure.

**CONTACT:** TODD HOLMAN  
**PHONE:** (239) 425-6014  
**E-MAIL:** tholman@wa-cr.com

# 1684 & 1685 Target Court, Fort Myers, FL 33905

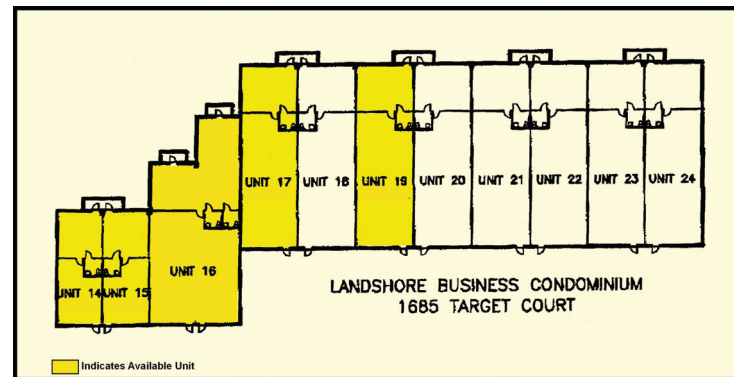
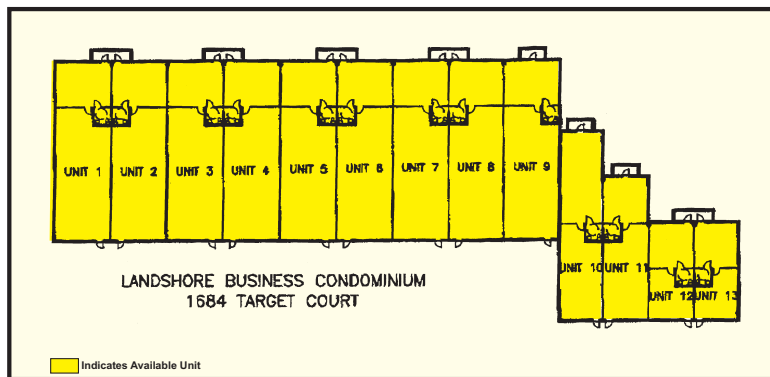
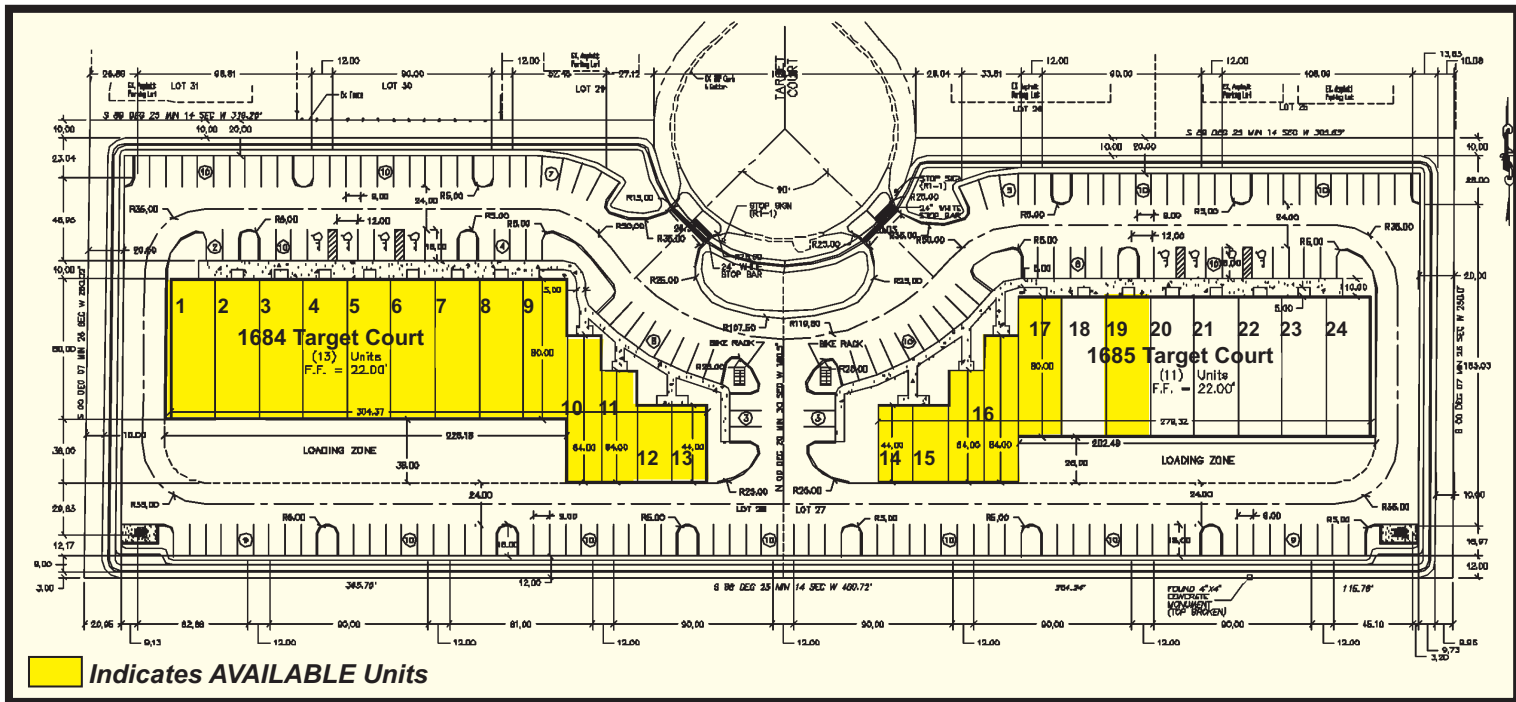
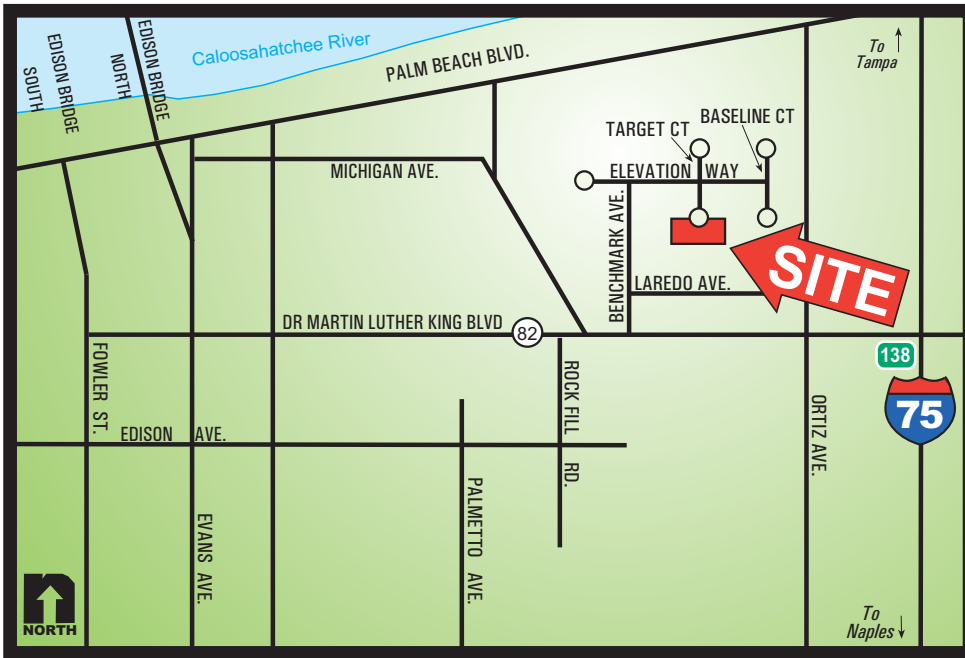

The statements and figures presented herein, while not guaranteed, are secured from sources we believe authoritative. Subject to prior sale, lease, withdrawal and price change without notice.