

North Cape Coral Industrial Park Warehouse with Yard Space FOR SALE



LOCATION: 923 NE 24th Lane, Cape Coral, FL 33909

STRAP #: 30-43-24-C4-00301.007B & .007E

ZONING: I1 - Industrial

SIZE: Building: 3,000± Sq. Ft
Land: 32,243± Sq. Ft. or .74± Acre

UTILITIES: City water and sewer **YEAR BUILT:** 1991

PRICE: \$745,000.00 **2005 TAXES:** \$3,477.01

COMMENTS: Warehouse building includes approximately 407± sq. ft. of office area, four 12' x 14' over head doors, drive-through configuration, two units which can be easily combined if desired, and large limerocked yard area. Located in the North Cape Coral Industrial Park just off of Kismet Pkwy.

CONTACT: JOHN KREMSKI, CCIM
(239) 425-6017

E-MAIL: john@johnkremski.com

WEB SITE: www.johnkremski.com

7051 Cypress Terrace
Suite 110, First Floor
Fort Myers, FL 33907
Phone: (239) 425-6000
Fax: (239) 425-6001
www.GDWFL.com

923 NE 24th Lane, Cape Coral, FL 33909

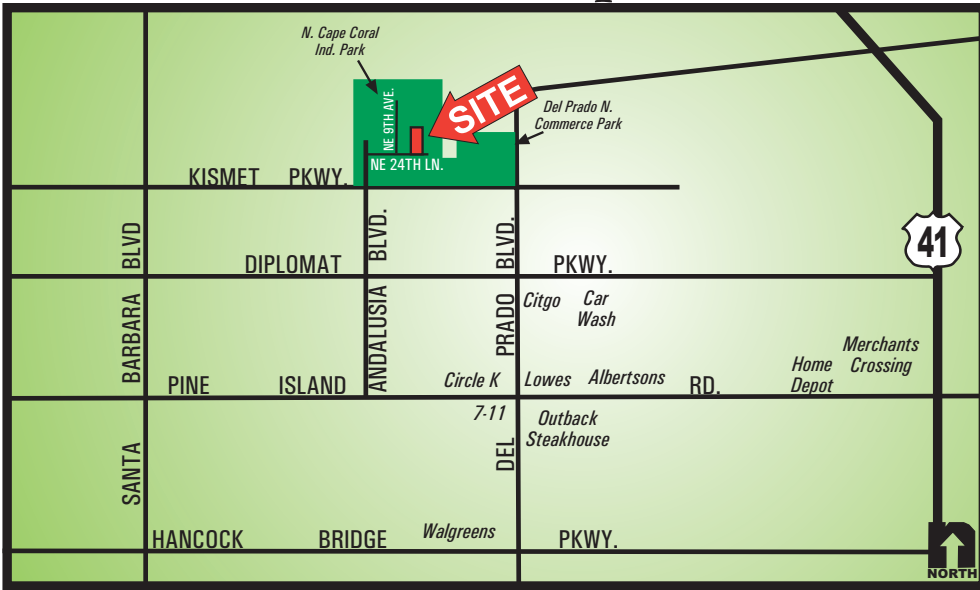

Site Plan

Floor Plan

