

Metro Commercial Park
Office / Warehouse Condo
FOR SALE



LOCATION: 12165 Metro Parkway, Unit 15-18, Fort Myers, FL 33912

ZONING: IL - Light Industrial

SIZE: 2,870± Sq. Ft. Total

UTILITIES: County Water & Sewer

PRICE: \$157,850

ASSN FEES: \$520.00 per Month

COMMENTS: Warehouse unit with one over head door, 600± sq. ft. office and one restroom. Located on the east side of Metro Parkway just north of Crystal Drive. See reverse side for more information. Unit available 06/01/15.

CONTACT: TODD HOLMAN
PHONE: (239) 425-6014
E-MAIL: tholman@wa-cr.com

12165 Metro Parkway, Unit 15-18, Fort Myers, FL 33912

Floor Plan

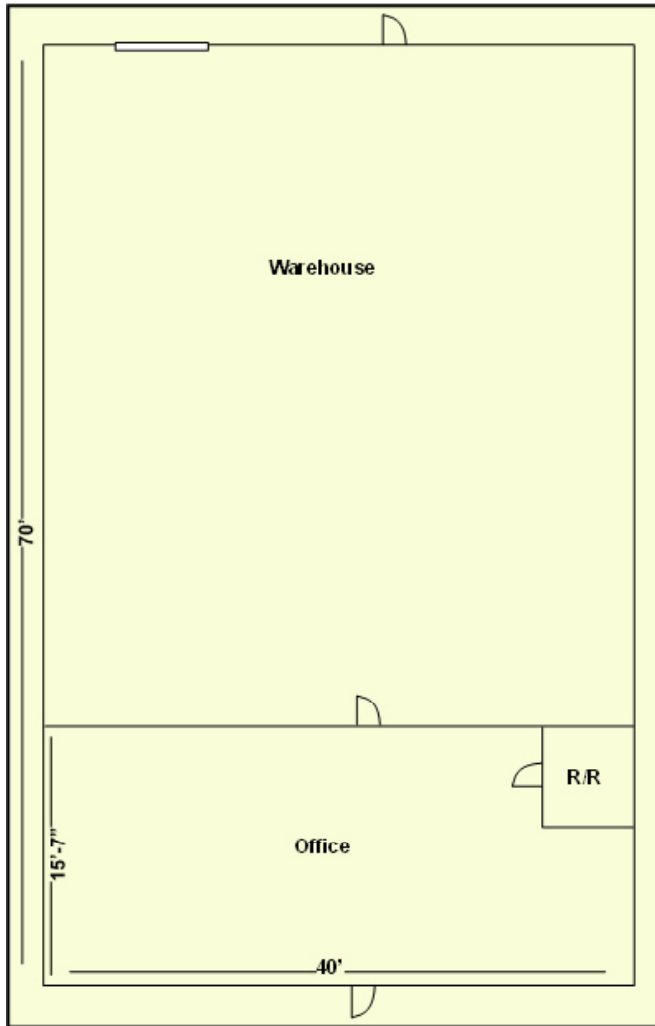

Site Plan

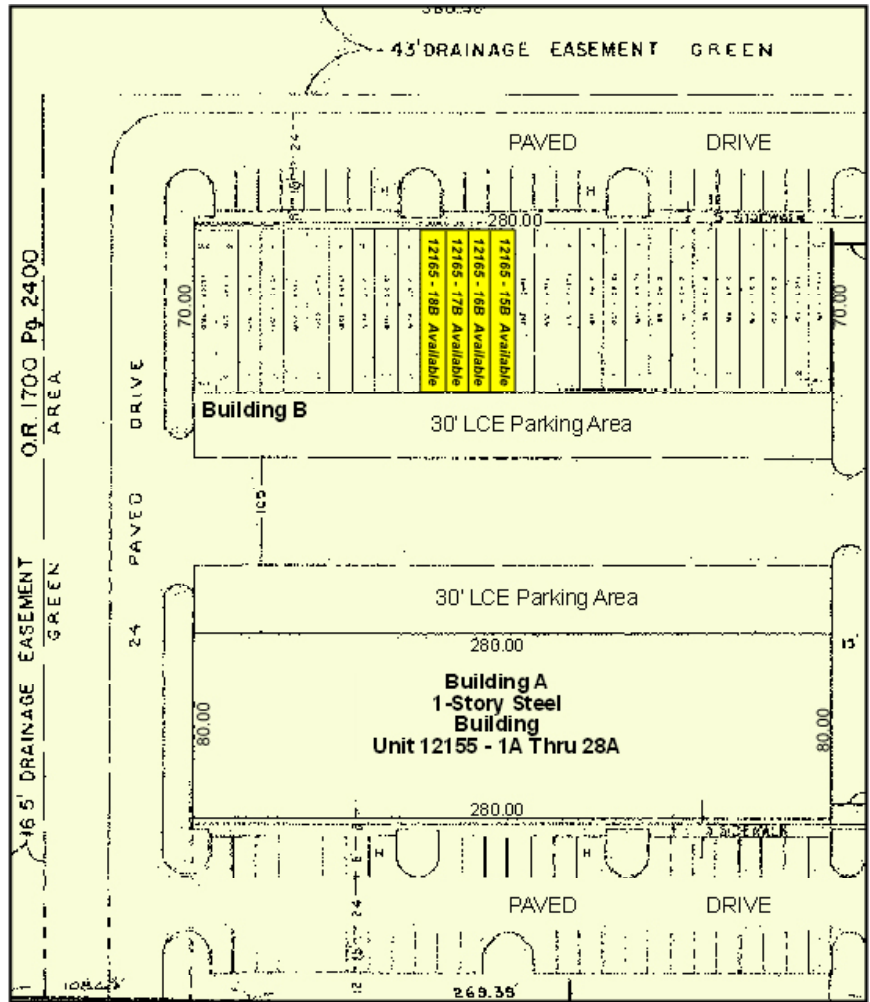

The statements and figures presented herein, while not guaranteed, are secured from sources we believe authoritative. Subject to prior sale, lease, withdrawal and price change without notice.