

**2,000 ± Sq. Ft.**  
**Office/Showroom**  
**FOR LEASE**



**LOCATION:** 6210 Plaza Drive, Fort Myers, FL 33905

**ZONING:** IPD - Industrial Planned Development

**STRAP #:** 15-44-25-03-00000.0080

**SIZE:** Building: 2,000± Sq. Ft.  
Land: 41,361± Sq. Ft. (0.95± Acres)

**O/H DOORS:** One 15' x 20'

**PRICE:** Building: \$1,333.00 Per Month (\$8.00 NNN per Sq. Ft.)  
Yard: \$3,000.00 plus Sales Tax  
Total: \$4,333.00 per Month NNN plus Sales Tax & CAM

**COMMENTS:** Freestanding office / showroom with one 15' x 20' covered dock door in the rear of the property. The large yard is completely fenced and paved. Located just off Exit 139 with excellent I-75 visibility and access at Exit 139.

**CONTACT:** TODD HOLMAN  
**PHONE:** (239) 425-6014  
**E-MAIL:** tholman@wa-cr.com

# 6210 Plaza Drive, Fort Myers, FL 33905

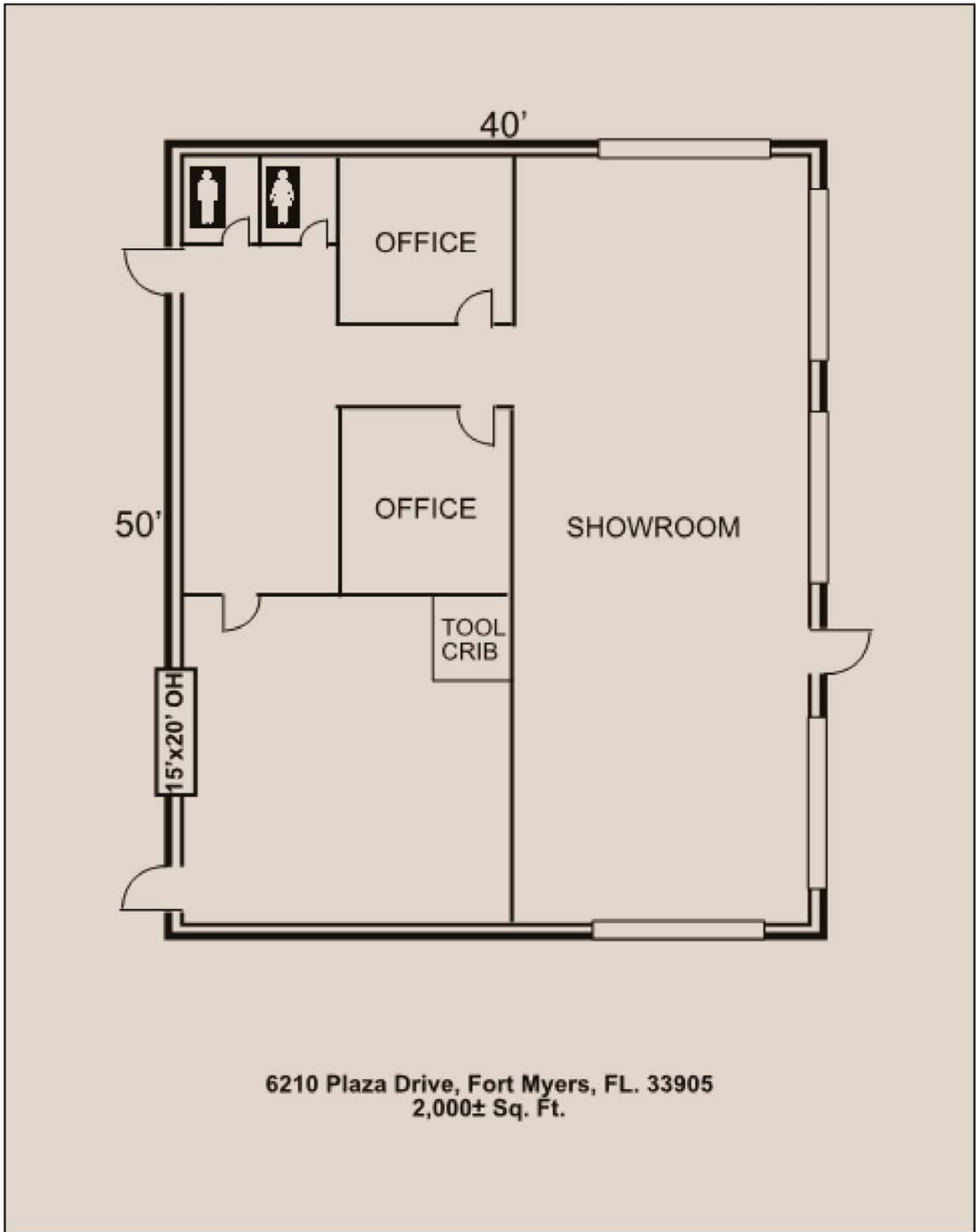

The statements and figures presented herein, while not guaranteed, are secured from sources we believe authoritative. Subject to prior sale, lease, withdrawal and price change without notice.

# 6210 Plaza Drive, Fort Myers, FL 33905



The statements and figures presented herein, while not guaranteed, are secured from sources we believe authoritative. Subject to prior sale, lease, withdrawal and price change without notice.

# 6210 Plaza Drive, Fort Myers, FL 33905

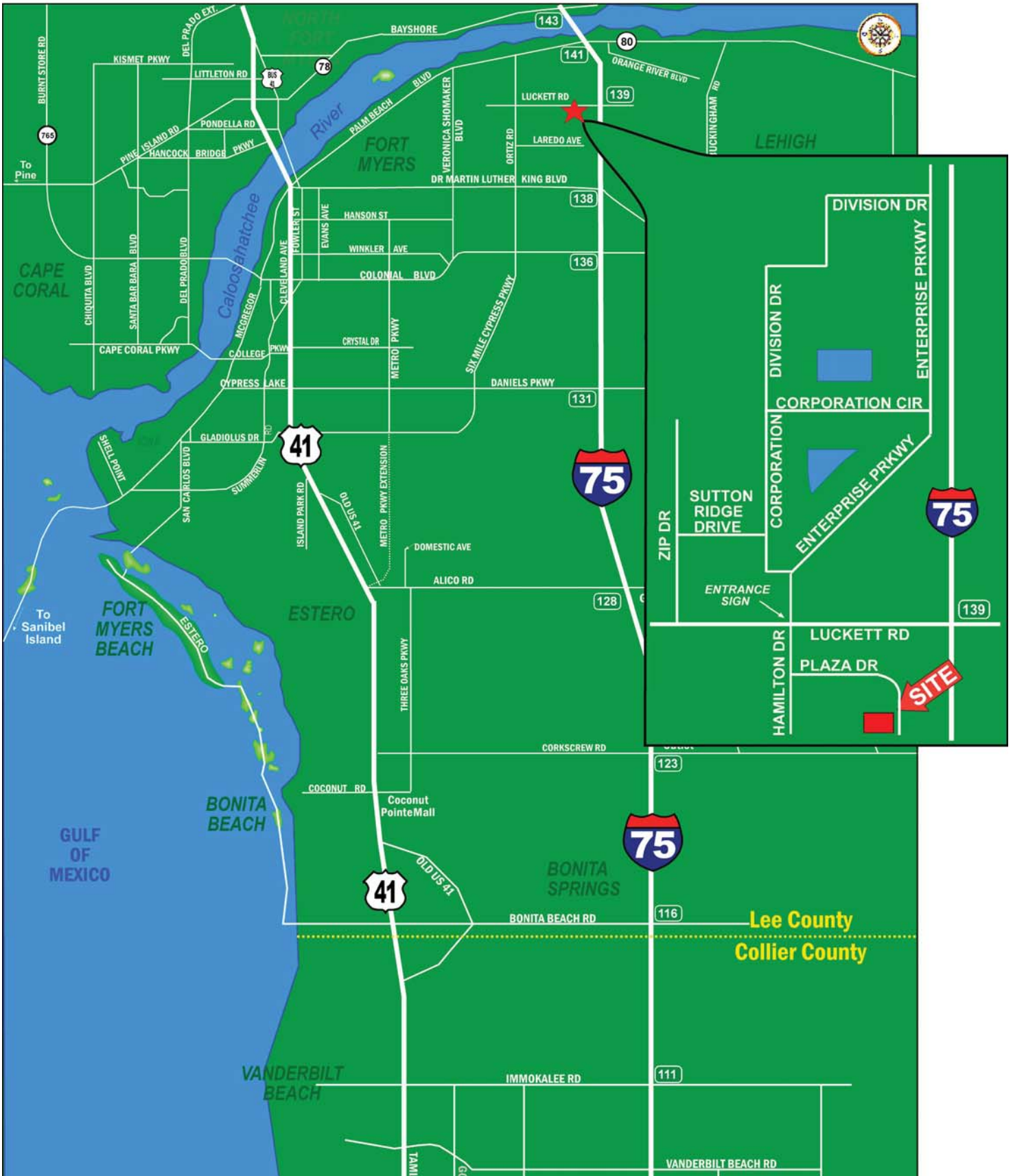

The statements and figures presented herein, while not guaranteed, are secured from sources we believe authoritative. Subject to prior sale, lease, withdrawal and price change without notice.